

# BOX SPRING DOOR

## 4" Curved Slat



**DAWN4DOOR®**  
ECONOMY BOX SPRING DOOR

Motor Operated  
Face mounted to Wall

Page#: Page 1

LG - Left Guide  
RG - Right Guide  
B - Bracket  
GW - Guide Width  
GD - Guide Depth

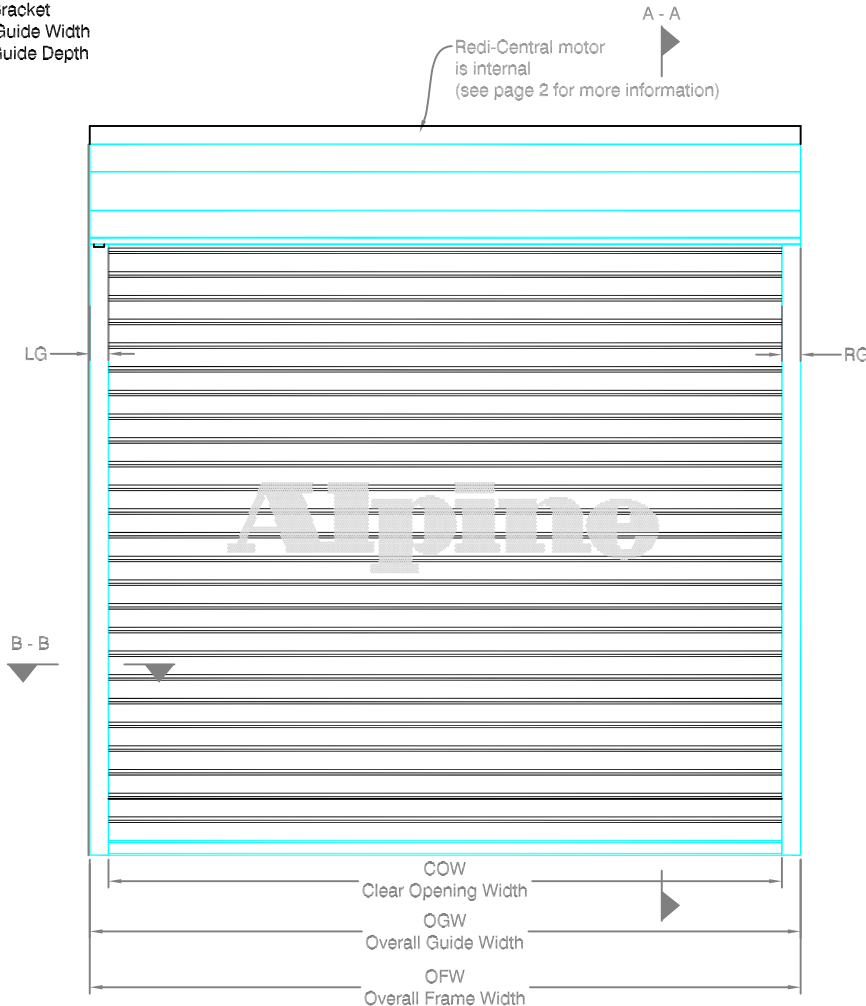

COIL SIDE ELEVATION

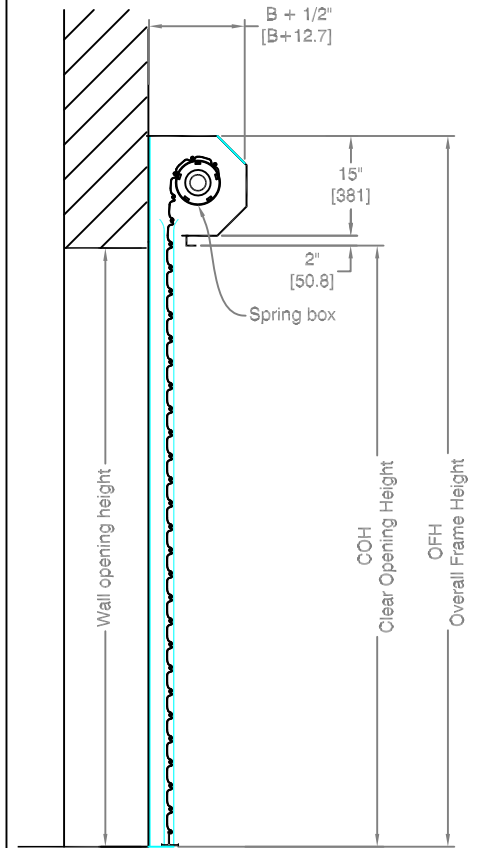

VERTICAL SECTION A - A

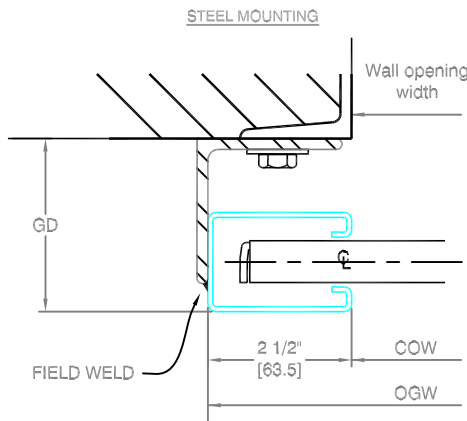
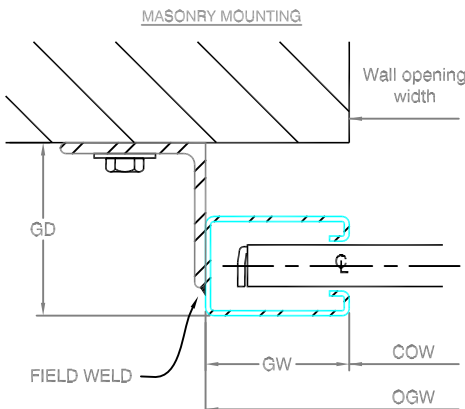

GUIDE SECTION B - B

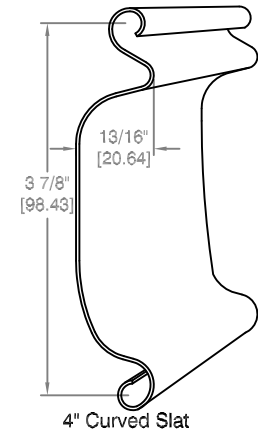

CURTAIN DETAILS

### Notes:

- See page 2 for more options.
- All metric conversions of dimensions are shown in brackets [ ].

SALES REP:

CUSTOMER:

JOB NAME:

NUMBER:

Manufactured by:

**Alpine®**  
OVERHEAD DOORS, INC.

8 HULSE ROAD EAST SETAUKET, N.Y. 11733

TEL: 631.473.9300 FAX: 631.642.0800

© COPYRIGHT APRIL 2005

# BOX SPRING DOOR

## 4" Curved Slat

**DAWN 4 DOOR**  
ECONOMY BOX SPRING DOOR

Motor Operated  
Face mounted to Wall

Page#: Page 2

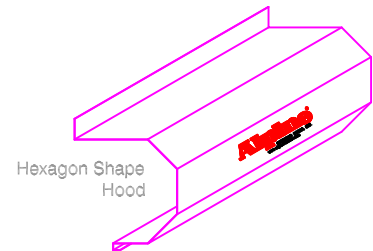
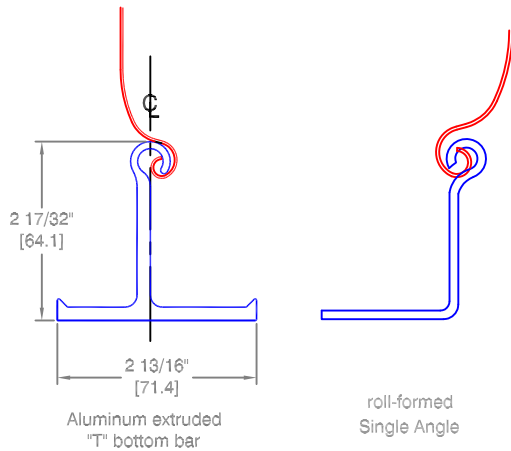

BOTTOM BAR OPTIONS AVAILABLE FOR THIS DOOR

HOOD SHAPE

## Redi-Central™

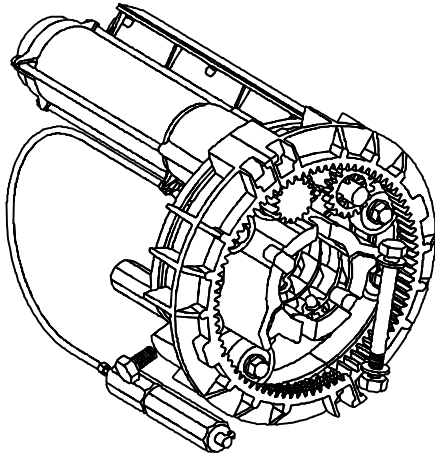

The Redi-Central box spring motor is designed to be used with Alpine's DAWN 4" DOOR. Used on store fronts, warehouse entrance doors, indoor/ outdoor flea markets and many other applications.

Redi-Central offers the convenience of motor operation with our DAWN 4" DOOR for an economical security door.

### FEATURES AND CHARACTERISTICS:

- 115V, 60 Hz, single phase
- U.L. Recognized
- Thermal protection
- Maximum continuous running time: 5 minutes
- Light duty cycle (6 cycles/hr)
- 2 3/8" fixed central shaft, adapters for smaller diameters
- Limit switch capacity of 11 revolutions

| Model     | Torque<br>(in lbs) | Speed<br>(rpm) | Lifting<br>capacity | Power usage |        | Options        |
|-----------|--------------------|----------------|---------------------|-------------|--------|----------------|
|           |                    |                |                     | (watts)     | (Amps) |                |
| MC 7 102  | 300                | 12             | 220                 | 300         | 3.0    | with brake     |
| MC 7 202  | 300                | 12             | 220                 | 300         | 3.0    | manual release |
| MCM 7 302 | 300                | 12             | 220                 | 300         | 3.0    | without brake  |
| MC 14 102 | 700                | 12             | 450                 | 580         | 5.0    | with brake     |
| MC 14 202 | 700                | 12             | 450                 | 580         | 5.0    | manual release |
| MCM14 302 | 700                | 12             | 450                 | 580         | 5.0    | without brake  |

Distributed By:

Call your Alpine representative for additional options and safety products to help find the best Alpine door to suit your needs.

Manufactured by:

**Alpine**  
OVERHEAD DOORS, INC.  
8 HULSE ROAD EAST SETAUKET, N.Y. 11733  
TEL: (631)473-9300 FAX: (631)642-0800  
© COPYRIGHT MAY 2007

NOTE: MAXIMUM PIPE DEFLECTION ON ANY SIZE DOOR IS .034



Page#:

Page 3

Finding the minimum required operation for the size door you need.

## Operator Legend

- Manual Push Up Operation
- Motor Operation Only

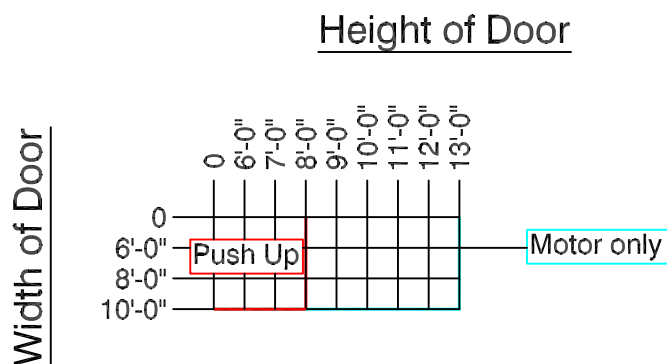

FOR LARGER SIZES CONSULT FACTORY.

To use Chart: Find where your door width and height meet to find the minimum operation that may be used for that door size.  
For example: The blue line indicates a Hand Crank Operation. Any size door on that line or above that line may use a Hand Crank, including the door sizes that fall into the Manual push up door. But, The Manual push up door may not be used for any door size below the line representing Push up operation. For any door size larger than what is represented here please consult your Alpine Overhead Doors, Inc. Factory. This Graph is for reference only, subject to change without notice.

Finding the minimum required bracket size for the door you need.

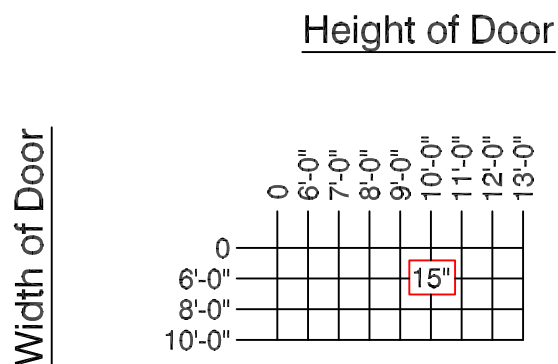

FOR LARGER SIZES CONSULT FACTORY.

NOTE: Bracket sizes may vary based on gauge of curtain. Bracket size is directly related to the pipe low moment arm deflection (not more than .03 inches per foot).

To use Chart: Find where your door width and height meet to find the minimum bracket size for your door. For any door size larger than what is represented here please consult your Alpine Overhead Doors, Inc. Factory. This Graph is for reference only, subject to change without notice.

Distributed By:

Manufactured by:

**Alpine**<sup>®</sup>  
OVERHEAD DOORS, INC.  
8 HULSE ROAD EAST SETAUKET, N.Y. 11733  
TEL: (631)473-9300 FAX: (631)642-0800  
© COPYRIGHT DEC 2006