

# Commercial & Industrial Doors

## 6" Curve Slat



### DOCK PORT 6" C

#### DOCK PORT 6" CURVE SLAT

Hand Chain Operated  
Face of Wall Mounted

Page#: Page 1

LG - Left Guide  
RG - Right Guide  
B - Bracket  
GW - Guide Width  
GD - Guide Depth

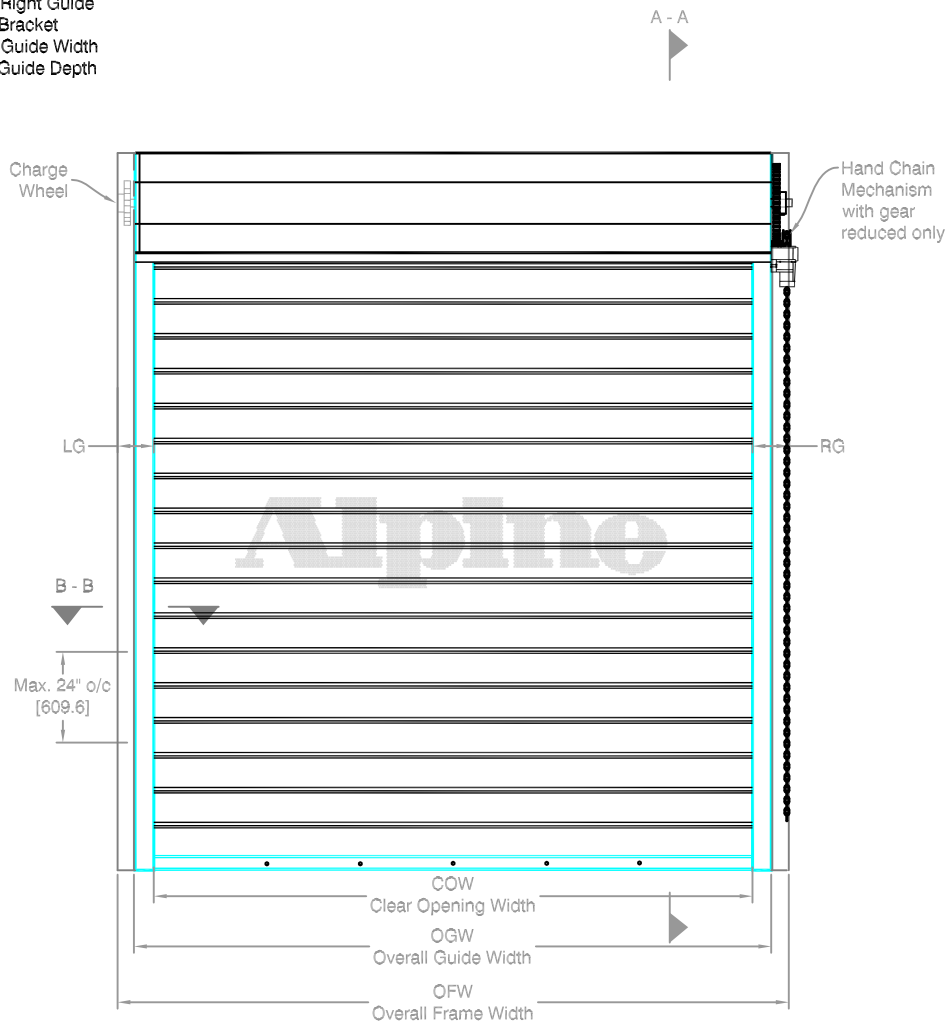

COIL SIDE ELEVATION

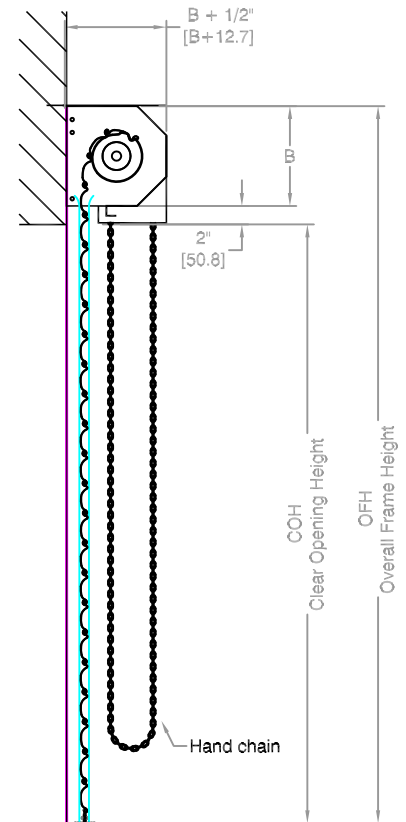

VERTICAL SECTION A - A

FACE MOUNTED TO MASONRY

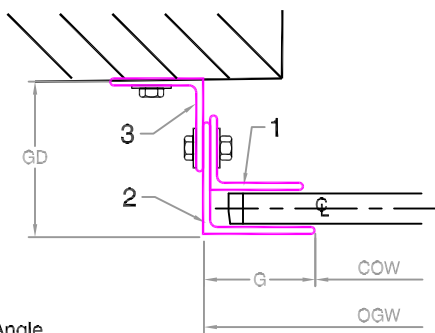

1- Inside Angle  
2- Outside Angle  
3- Wall Angle

FACE MOUNTED TO STEEL

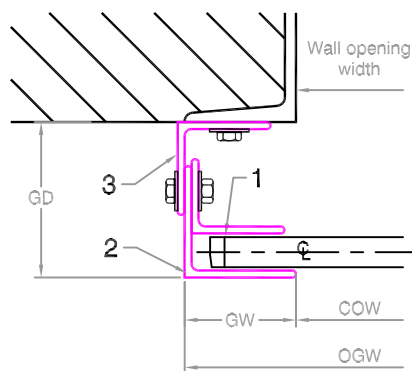

FACE MOUNTED TO TUBE

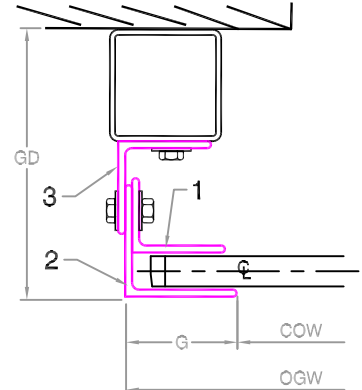

GUIDE SECTION B - B

#### Notes:

- See page 2 for more options.
- All metric conversions of dimensions are shown in brackets [ ].

SALES REP:

CUSTOMER:

JOB NAME:

NUMBER:

Manufactured by:

**Alpine**<sup>®</sup>  
OVERHEAD DOORS, INC.

8 HULSE ROAD EAST SETAUKET, N.Y. 11733

TEL: (631)473-9300 FAX: (631)642-0800

© COPYRIGHT JAN 2007

DOCK PORT 6" C

Hand Chain Operated

Face of Wall Mounted

DOCK PORT 6" CURVE SLAT

Page#:

Page 2

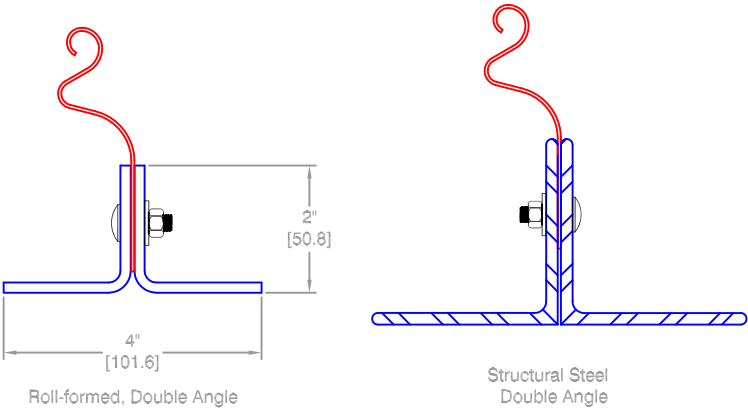

Neoprene Astragal

BOTTOM BAR OPTIONS

OBSTACLE EDGES AVAILABLE

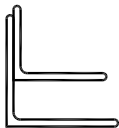
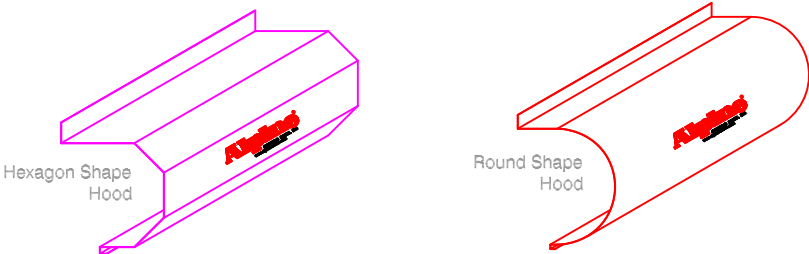

Structural Angles Guide

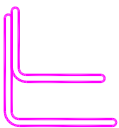

Roll-Formed Angles Guide

HOOD SHAPE OPTIONS

GUIDE OPTIONS

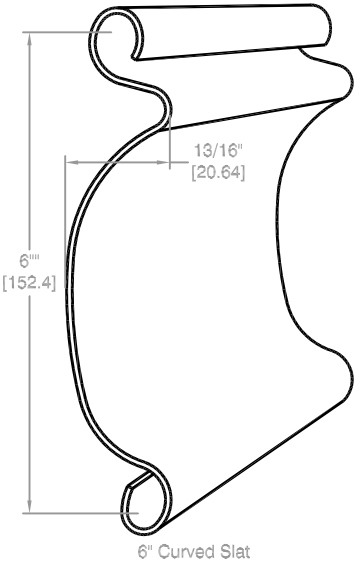

6" Curved Slat

CURTAIN DETAIL

Distributed By:

Call your Alpine representative for additional options and safty products to help find the best Alpine door to suit your needs.

Manufactured by:

**Alpine**<sup>®</sup>

OVERHEAD DOORS, INC.

8 HULSE ROAD EAST SETAUKET, N.Y. 11733

TEL: (631)473-9300 FAX: (631)642-0800

© COPYRIGHT MAY 2007