

# Wooden Counter-Shutter Door



**Wooden Counter Shutters**  
 Beautifying your space

Motor Operated  
 Face of Wall Mounted

Page#:

Page 1

LG - Left Guide  
 RG - Right Guide  
 B - Bracket  
 GW - Guide Width  
 GD - Guide Depth

Door is shown right hand drive, left hand is opposite.

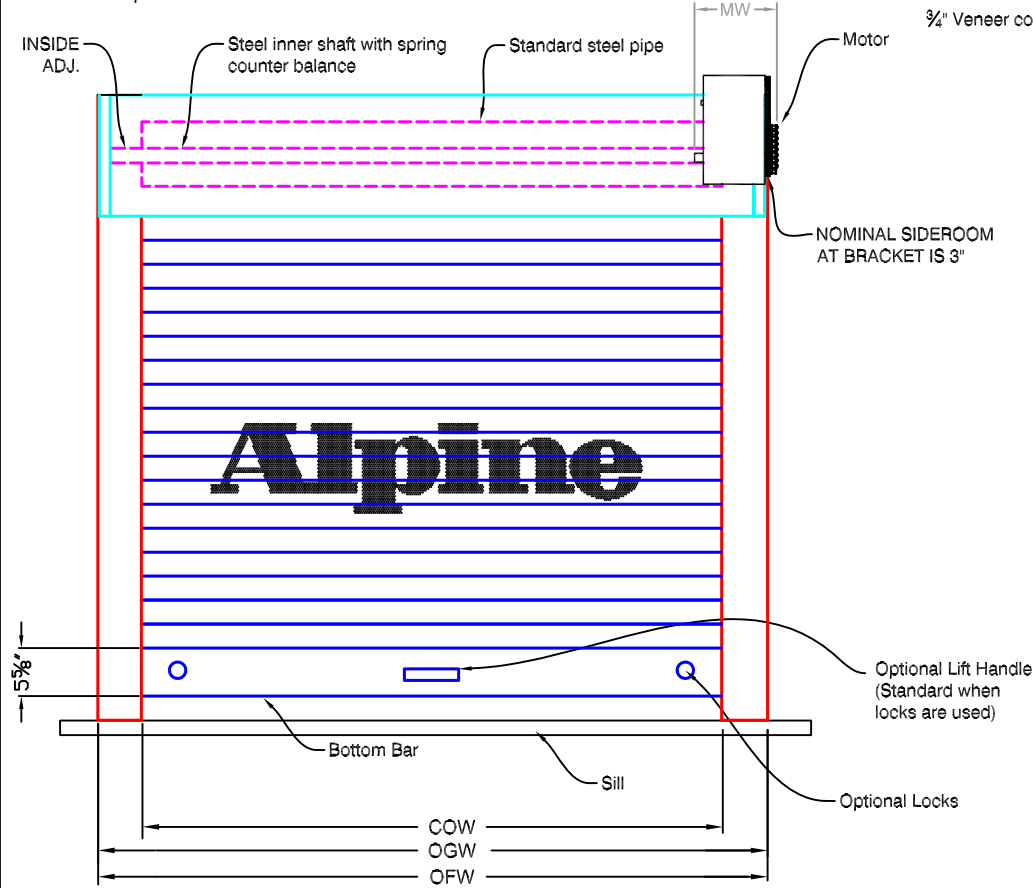

COIL SIDE ELEVATION

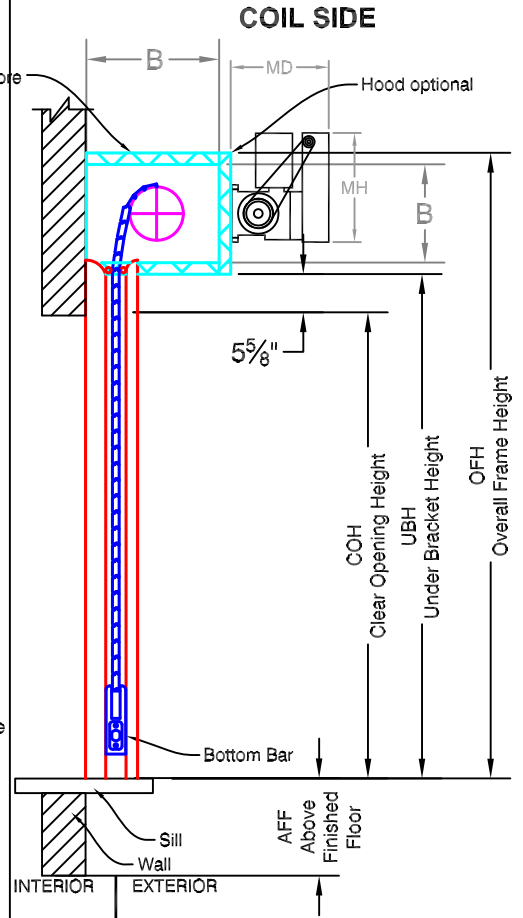

VERTICAL SECTION A - A

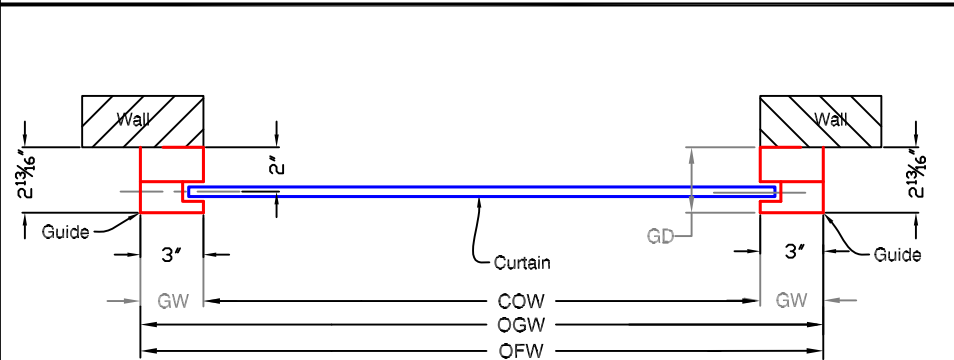

GUIDE SECTION

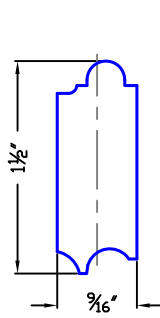

SLAT PROFILE

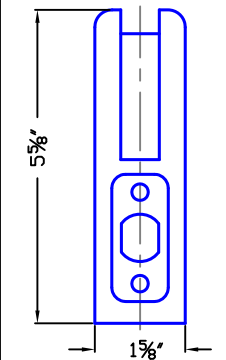

BBAR PROFILE

CURTAIN

BOTTOM BAR

**Notes:**

- See page 2 for more options.
- All metric conversions of dimensions are shown in brackets [ ].

SALES REP: \_\_\_\_\_  
 CUSTOMER: \_\_\_\_\_  
 JOB NAME: \_\_\_\_\_  
 NUMBER: \_\_\_\_\_

Manufactured by:



8 HULSE ROAD EAST SETAUKET, N.Y. 11733  
 TEL: (631)473-9300 FAX: (631)642-0800  
 © COPYRIGHT MAY 2007

# Wooden Counter-Shutter Door



Motor Operated  
Face of Wall Mounted

Page#:

Page 2

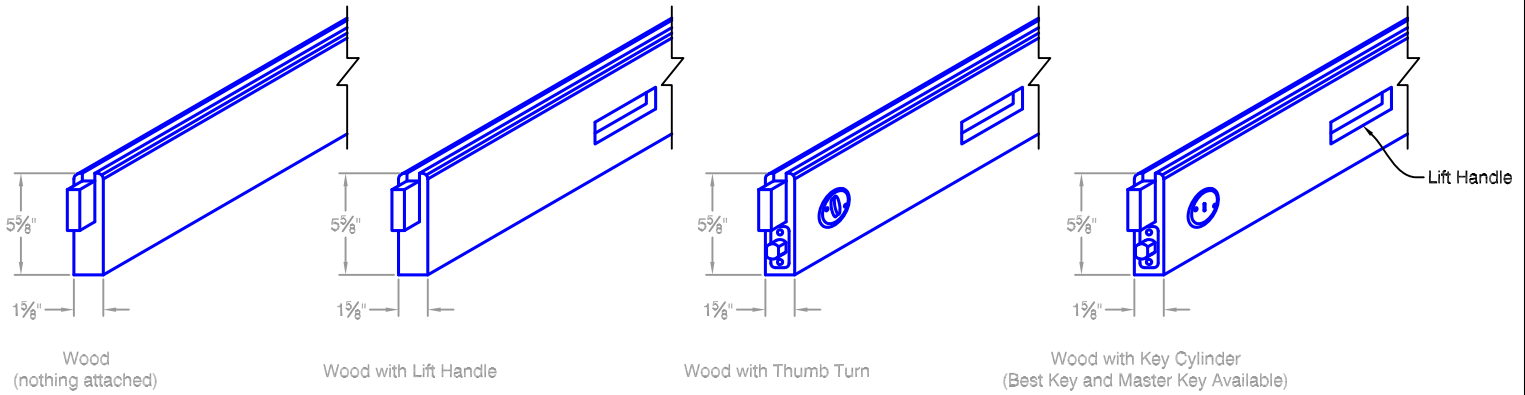

## BOTTOM BAR OPTIONS AVAILABLE FOR THIS DOOR

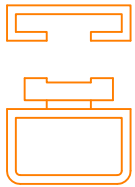

Neoprene Astragal

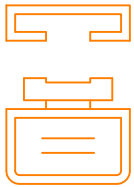

Electric Sensing Edge

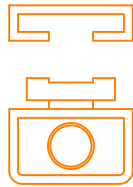

Pneumatic Sensing Edge

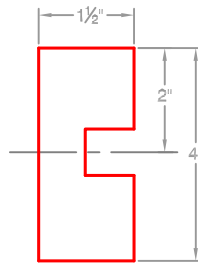

Standard Wood Guide

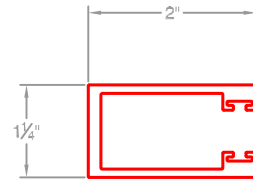

Aluminum Guide  
(between jambs)

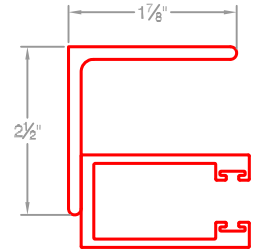

Aluminum Guide  
(face of wall)

## OPTIONAL EDGES AVAILABLE

## GUIDES AVAILABLE FOR THIS DOOR

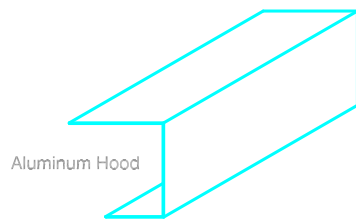

Aluminum Hood

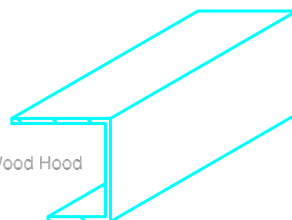

Wood Hood

## HOOD SHAPES AVAILABLE FOR THIS DOOR

Distributed By:

Call your Alpine representative for additional options and safety products to help find the best Alpine door to suit your needs.

Manufactured by:

**Alpine**<sup>®</sup>  
OVERHEAD DOORS, INC.  
8 HULSE ROAD EAST SETAUKET, N.Y. 11733  
TEL: (631)473-9300 FAX: (631)642-0800  
© COPYRIGHT MAY 2007