



# INTRODUCTION

---

Dear Customer,

***Congratulations on your purchase of the Alpine Integral frame door. You have selected a product that has been manufactured with the latest and most advanced technology available within the industry. Computer aided design and LASER quality machining have been incorporated into all Alpine products.***

## SAFETY INSTRUCTIONS

**IT IS IMPORTANT TO READ ALL SAFETY INSTRUCTIONS BEFORE BEGINNING INSTALLATION!**

### UPON ARRIVAL OF THE SHIPMENT TO THE PROJECT LOCATION

1. Check all materials against the packing list. Inspect all materials for any visible or concealed signs of freight damage. Should omissions or freight damage be present, you must file a freight claim.
2. If you have received more than one door, you will notice that all major parts and components of that door are marked with corresponding numbers. A complete door should be composed of all parts bearing the same numbers.

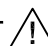
 **IMPORTANT**  Do not interchange door parts from one door to another!

3. Before leaving the project site, make certain that you have read and have fully complied with the safety checklist. Complete the fire door drop test report and return it to the Alpine office.

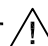
 **IMPORTANT**  **INSTALLATION OF THIS DOOR MUST BE PERFORMED BY AN EXPERIENCED INSTALLER!**

### NOTE TO THE INSTALLER:

In order to assure your customer that this door has been installed in a safe and efficient manner, Alpine recommends that you thoroughly check the following areas before leaving the project site.

1. Make certain that the proper amount of tension has been applied to the torsion spring assembly, in order to counterbalance the weight of the curtain.
2. Make sure that the tension wheel is securely fastened in place.
3. Make sure that all keys have been installed in any sprockets or gears that require them. Make sure that all set screws have been installed and are properly tightened.
4. Check all fasteners that hold the guides to the building structure.
5. Check all fasteners used in assembling the various door components.

# PREPARATION

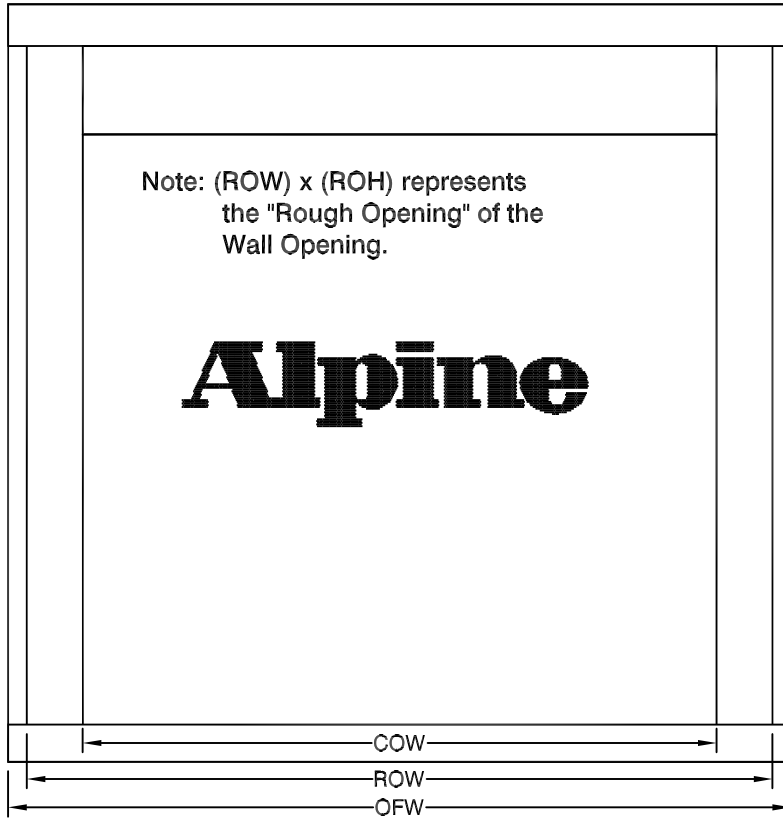

COIL SIDE ELEVATION

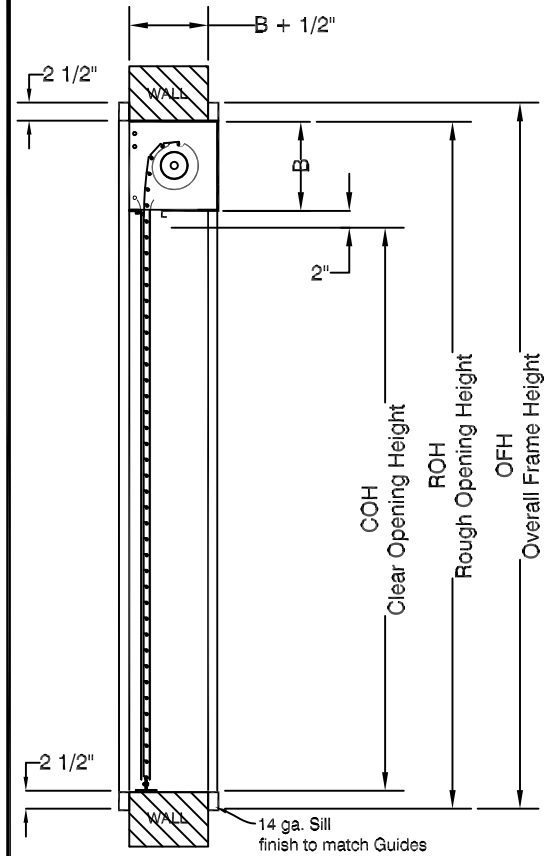

VERTICAL SECTION

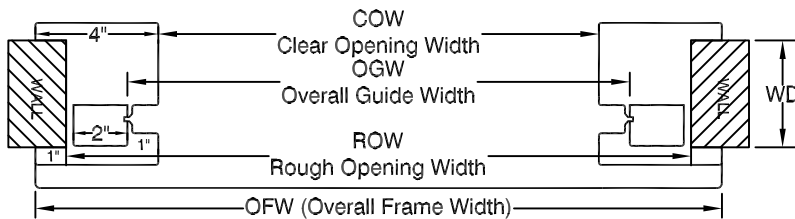

GUIDE SECTION

CURTAIN

BOTTOM BAR

QUANTITY	MARK	CLEAR OPENING		OVERALL GUIDE	ROUGH OPENING		OVERALL FRAME		Bracket	Wall Depth	DRIVE	OPERATION
Q	M	COWIDTH	COHEIGHT	OGWIDTH	ROWIDTH	ROHEIGHT	OFWIDTH	OFHEIGHT	B	WD	DR	OP

Manual (Push up)

- a. **Wind Load:** Doors are designed to withstand P.S.F while in fully closed position
- b. 1-1/2 Hours fire-Rated.

**BUILDINGS NOTES:**

1. Jambs, Lintels, Sills or other structural elements required to prepare opening are not included by **Alpine Overhead Doors, Inc.**
2. Opening of sound and suitable construction will be provided by the purchaser for the support of **Alpine Overhead Doors, Inc.**
3. In the construction of new openings, the purchaser will be responsible for the maintenance of certified dimensions on approved shop drawings or as guaranteed otherwise.
4. Set Frame to the (ROW) x (ROH) dimension. Note: The Opening must be built in accordance with NFPA 80.

# PREPARATION

Note: Governor and Drop-Arms not used with a Redi-Reset Operator.

## STANDARD PARTS:

For Conventional Type Fire-Shut Operator.

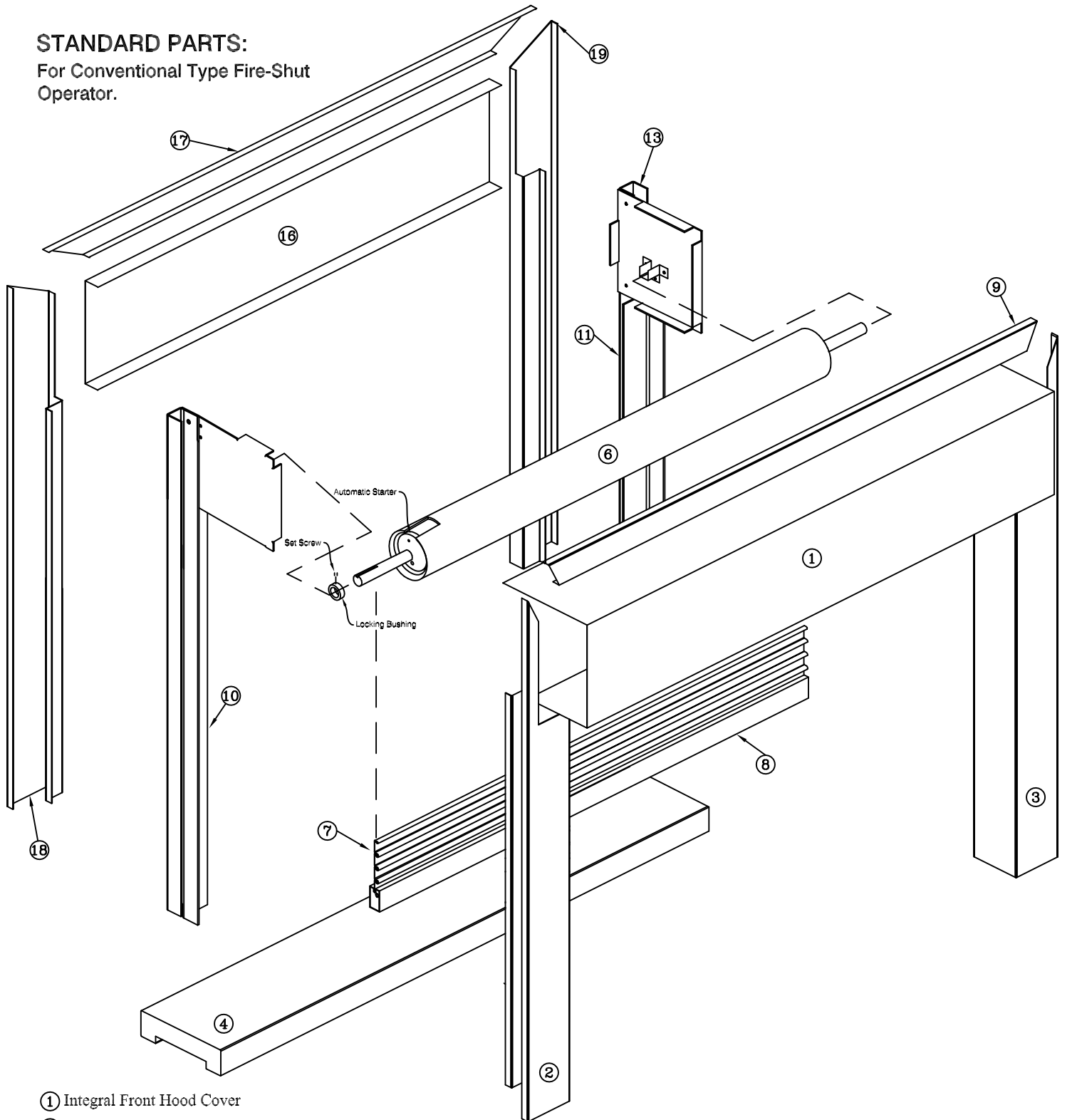

- ① Integral Front Hood Cover
- ② Integral Front Guide Frame L.H.
- ③ Integral Front Guide Frame R.H.
- ④ Integral Frame Sill
- ⑥ Counter Balance Barrel
- ⑦ Curtain Assembly
- ⑧ Tubular Bottom Bar
- ⑨ Integral Front Header Frame
- ⑩ Integral Tubular Assembly L.H.
- ⑪ Integral Tubular Assembly R.H.
- ⑬ Integral Frame Bracket Plate R.H.
- ⑰ Integral Back Fascia
- ⑱ Integral Back Header Frame
- ⑲ Integral Back Frame L.H.
- ⑳ Integral Back Frame R.H.

# INSTALLATION

## 1

### Frame Assembly

Verify the opening size, width and height, and mounting condition of the opening. Your opening must comply with NFPA 80 standards.

**! IMPORTANT !** Determine your mounting configuration to ensure compliance with fig. 3 through fig. 11, for proper mounting conditions, in accordance with NFPA 80 (latest edition)

#### B. Frame Mounting Assembly

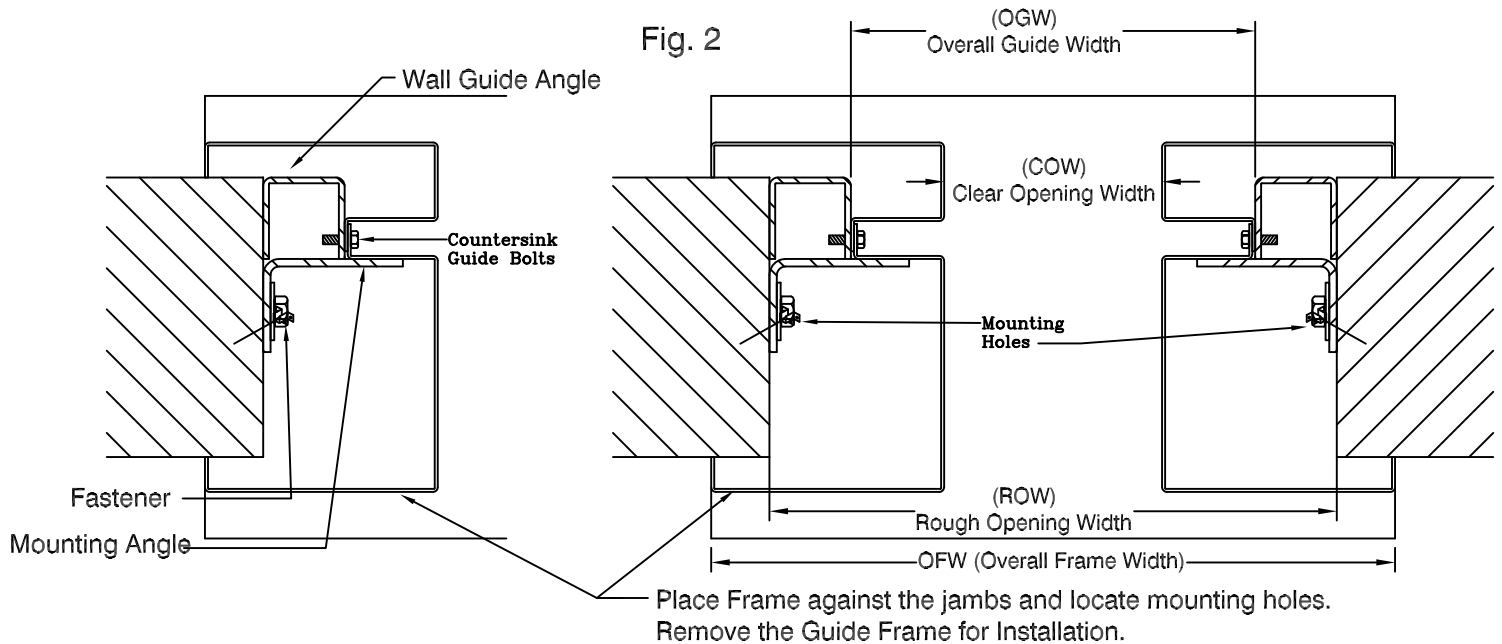

## 1A

### Frame Disassembly (disassemble the Knock-Down Door)

Verify the opening size, width and height, and mounting condition of the opening. Your opening must comply with NFPA 80 standards.

Verify the ROW x ROH for the opening space in the wall.

Note: The Integral Frame is shipped fully assembled. In order to install the frame, the Installer must Knock-Down the frame by :

- 1) Remove the Hood Cover by locating the two screws on front of hood (fig.3)

Fig. 3

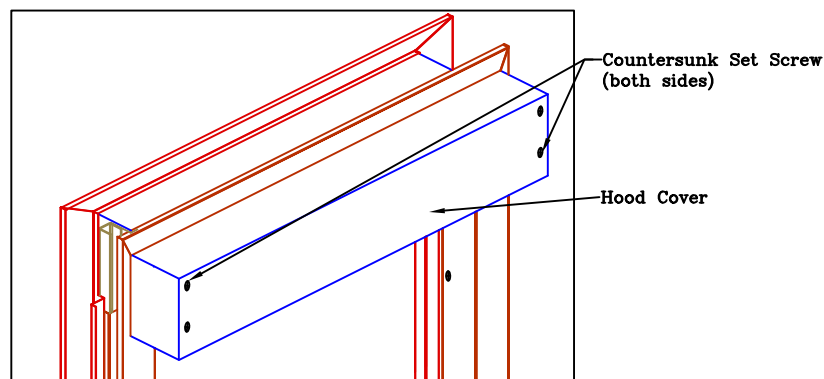

# INSTALLATION

- 2) Remove the two set screws located on the side of the frame and the underside of the top frame. Now you will be able to lift and slide the top of the frame off of the unit. (fig. 4)
- 3) Roll Curtain up, while in a rolled up position tie it up so it will not uncoil.(fig. 4A)
- 4) Remove the set screws that are located inside the guide on each side of the frame. (these screws are countersunk). (fig. 4B)

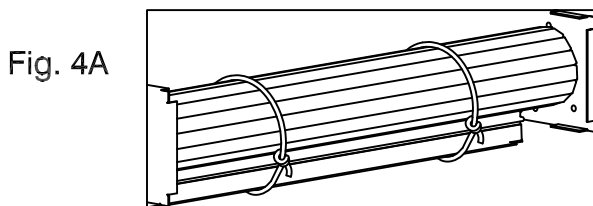
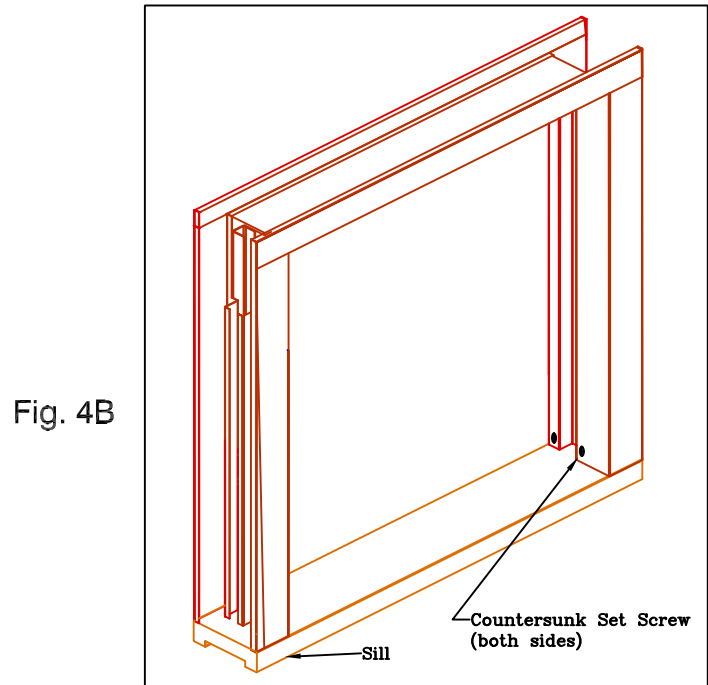
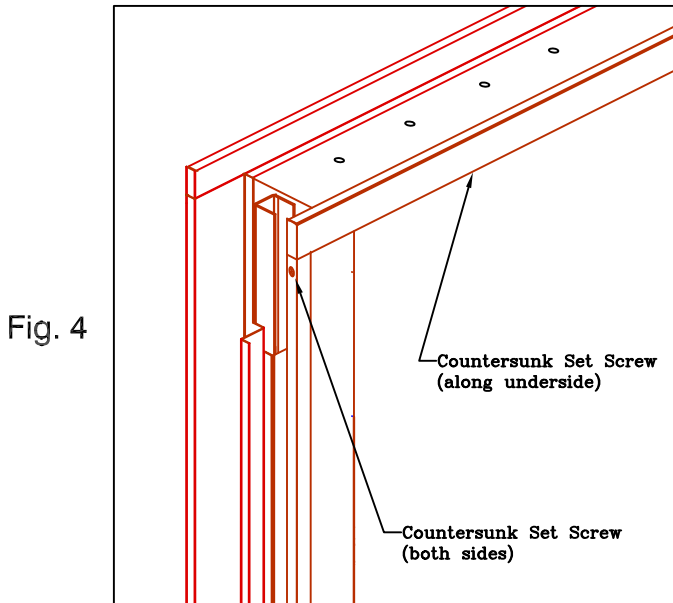

- 5) Remove the bolts and set screws located on the bottom of the sill, which are also countersunk screws. (fig. 5 & fig. 6)

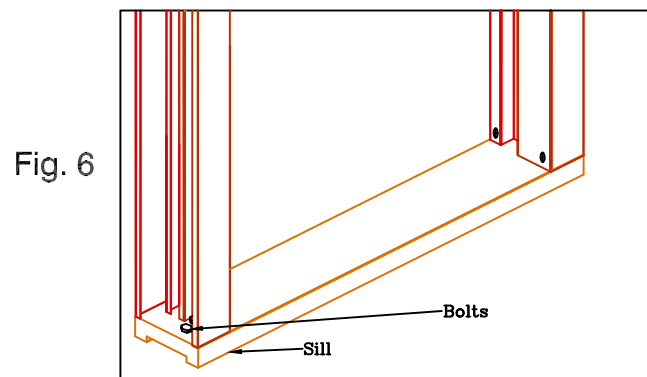
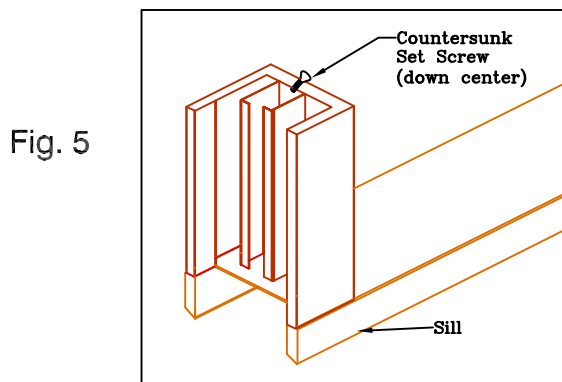

# INSTALLATION

---

⚠ IMPORTANT ⚠ THE TOP OF EACH WALL/GUIDE ASSEMBLY MUST BE LEVEL AND SQUARE.

6) Remove the Bottom Sill and install sill in the new opening, Tilted up on one side, so one side at a time may be lowered into wall opening. (fig.7) Tilt and install the Knock Down Frame into the opening and bolt the sill to the frame using the disassembly instructions of the Knock-Down Frame in reverse.

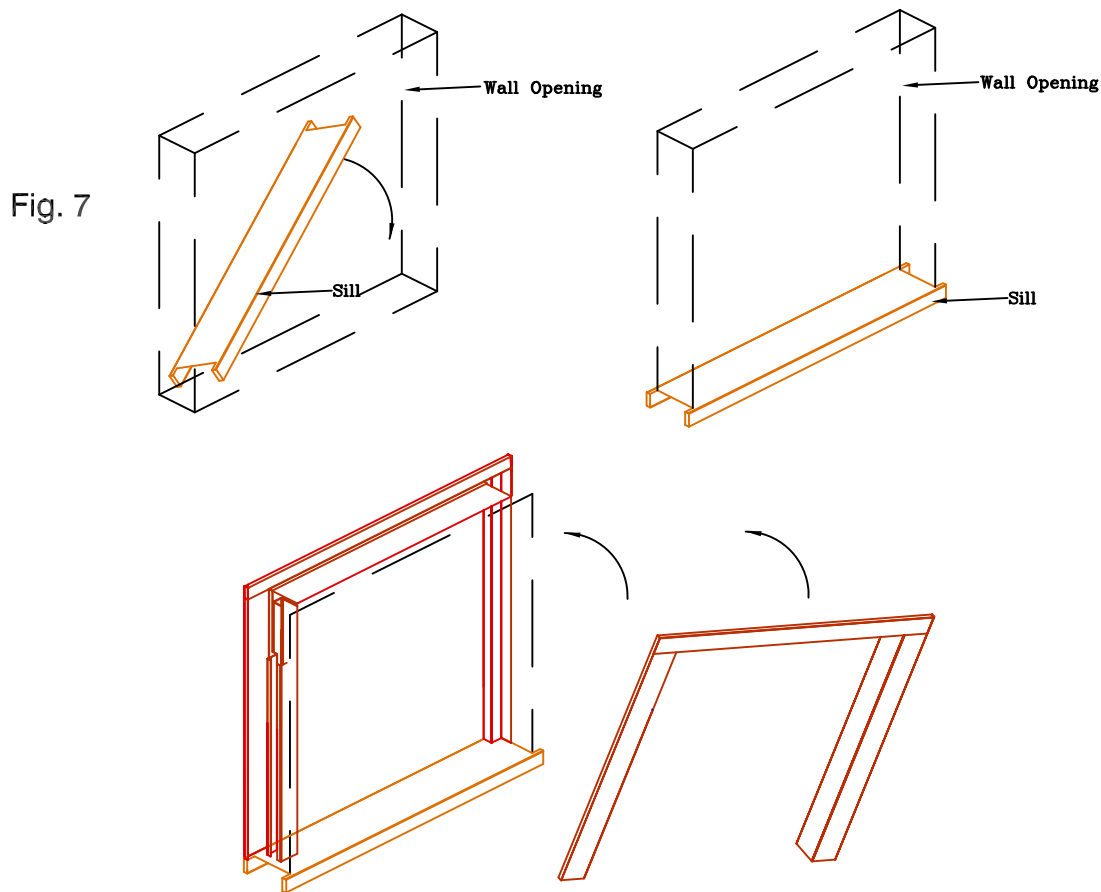

**Note: Upon Completion, If any gaps or spacing exists between the tube and jamb, an approved method of fire-proofing must be applied.**

# INSTALLATION

7) a. When fastening to masonry (brick, block or concrete) using expansion anchors, anchorage depth is not to be less than 8 times the bolt dia. and not less than 6 times the bolt dia. from the edge of the opening, as shown in Fig. 8. Fasten using a minimum of 3/8" dia. fasteners equal to that specified in the latest edition of NFPA 80 section 6-4.1.3.

b. When fastening to a wall to masonry (brick, block or concrete) drill holes completely through the wall with a 1/2" dia. masonry drill or with the mfg. suggested drill size (see fasteners Instructions). Fasten with a minimum 3/8" bolt, as shown in Fig. 8.

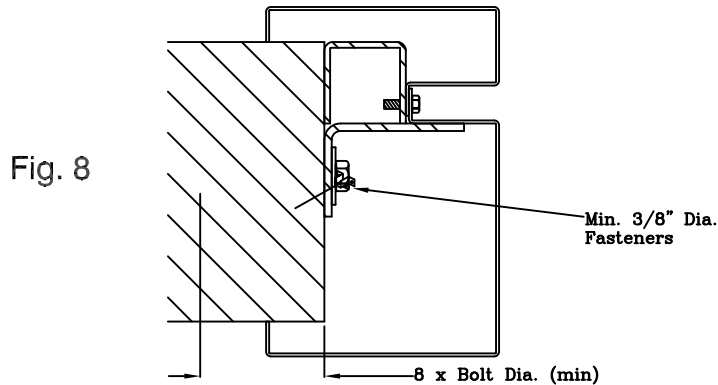

c. When fastening to a steel frame, drill and tap holes for the appropriate fastener size. Fasten as shown in Fig. 9 with a min. of 3/8" dia. fasteners equal to that specified in the latest edition of NFPA 80 section 6-4.1.4. Note: Steel frame member must be embedded or secured to the masonry wall prior to the wall / guide assembly to them.

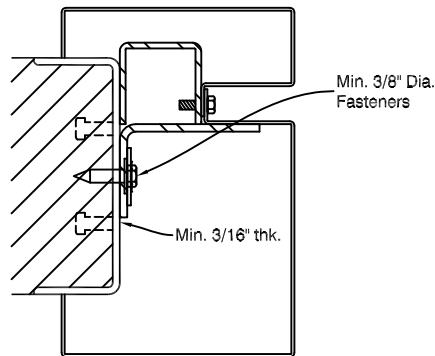

Fig. 9

d. When fastening to a double(2) metal stud jamb, each stud is to be minimum of 14 gauge. Fasten using a min. of 3/8" dia. self-tapping screws, as shown in Fig. 10.

e. When fastening to a double(2) wood stud jamb, each stud is to be a min. 2"x 4". Fasten using a min. of 3/8" dia lag screws, as shown in Fig. 11.

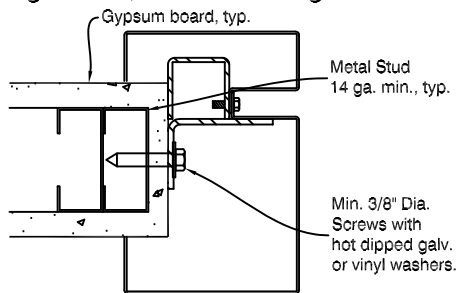

Fig. 10

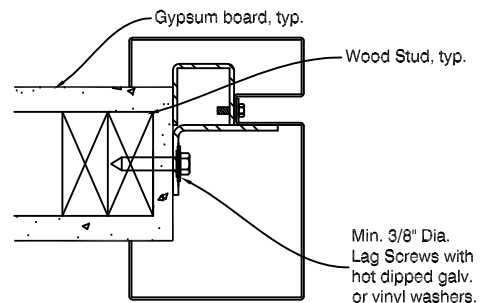

Fig. 11

**Note:** When all fasteners have been attached and the Knock Down Frame is assembled into the opening, Verify that the Counterbalance assembly is balanced by making necessary adjustments for ease of operation. Also insure that all screws and fasteners are not loose from shipping.



# INSTALLATION

---

⚠ IMPORTANT ⚠ UNDER NO CIRCUMSTANCES SHOULD TENSION BE APPLIED WHEN THE DOOR IS IN THE CLOSED POSITION.

## 4

### Mount Hood

*Install the hood to the flanges on the brackets by using #10 self-drilling sheet metal screws.*

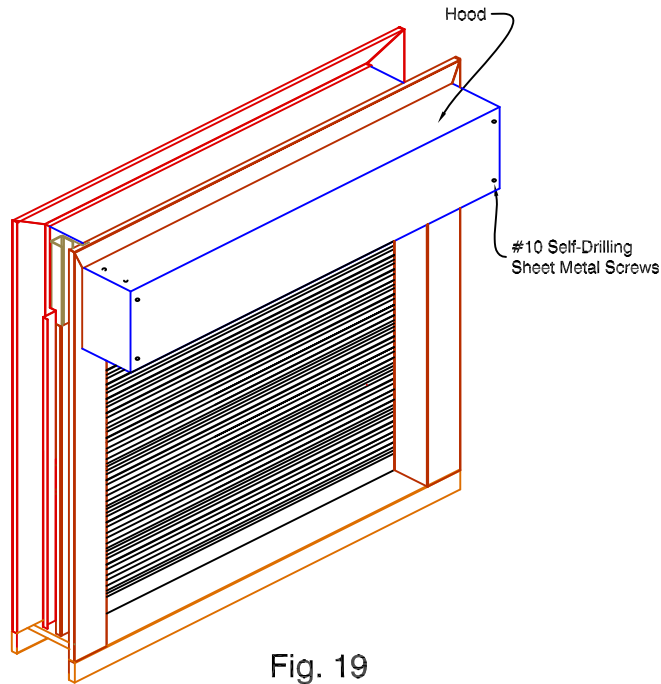

Fig. 19

## MAINTENANCE INSTRUCTIONS



**ONLY EXPERIENCED PERSONNEL SHOULD PERFORM MAINTENANCE**

### LUBRICATION

The most important maintenance item on doors of this type is lubrication.

The curtain, guides and teeth of the gears contained in motor or hand crank mechanism (if supplied) should be lubricated at least twice a year (more often if door works very frequently) with one of the following greases, or equivalent:

- Dixon's #2 Graphite Cup Grease (#1 for summer weather)
- Alemite MP Lithium Grease (#1 for winter weather, #2 for normal)
- Texaco #904 Graphite Grease

If door is electrically operated, check the oil level in the worm gear speed reducer every six months and replenish if necessary with S.A.E 140 gear oil, for normally heated buildings, thinner grades for outside installations exposed to low temperatures.

### PAINT

All non-lubricated steel surfaces should be painted annually (more often if required in corrosive atmospheres) with a good grade of rust inhibiting metallic base paint.

### SPRING ADJUSTMENT

In time, the counter balancing springs may lose some of their initial tension; this condition imposes an extra load on the operator and should be corrected as follows:

- 1a) Manually operated doors should be opened fully by hand and held open by "C" clamps or Vice grip pliers on each guide.
- 1b) Mechanically operated doors should be opened fully and the crank or hand chain should be locked to hold the door open.
- 1c) Electrically operated doors should be open fully by pushing the UP or OPEN button (motor brake will hold the door open) shut off power supply to the motor during adjustment.
- 2) With suitable tool (18" or 24" pipe wrench or larger spanner) turn the spring adjusting wheel (1/8 turn at a time) until the door is balanced properly. Make sure pawl is properly engaged in spring adjusting wheel.